

WARNER PARK BOAT LAUNCH PARKING LOT RECONSTRUCTION

CONTRACT NUMBER: 8220

MUNIS NOs: 17381 -51 -130

PROJECT LOCATION
(1101 WOODWARD DR
MADISON, WI)

INDEX OF SHEETS

SHEET NO.	TITLE
SHEET NO. 1	
SHEET NO. P-1	SITE ACCESS AND EROSION CONTROL
SHEET NO. P-2	REMOVALS
SHEET NO. P-3	SITE GRADING
SHEET NO. P-4	RESTORATION AND MATERIALS
SHEET NO. P-5	TRAFFIC MARKING AND SIGNAGE
SHEET NO. D1-D3	DETAILS
SHEET NO. E1-E3	ELECTRICAL AND LIGHTING PLANS
SHEET NO. E4-E5	LIGHTING PLAN

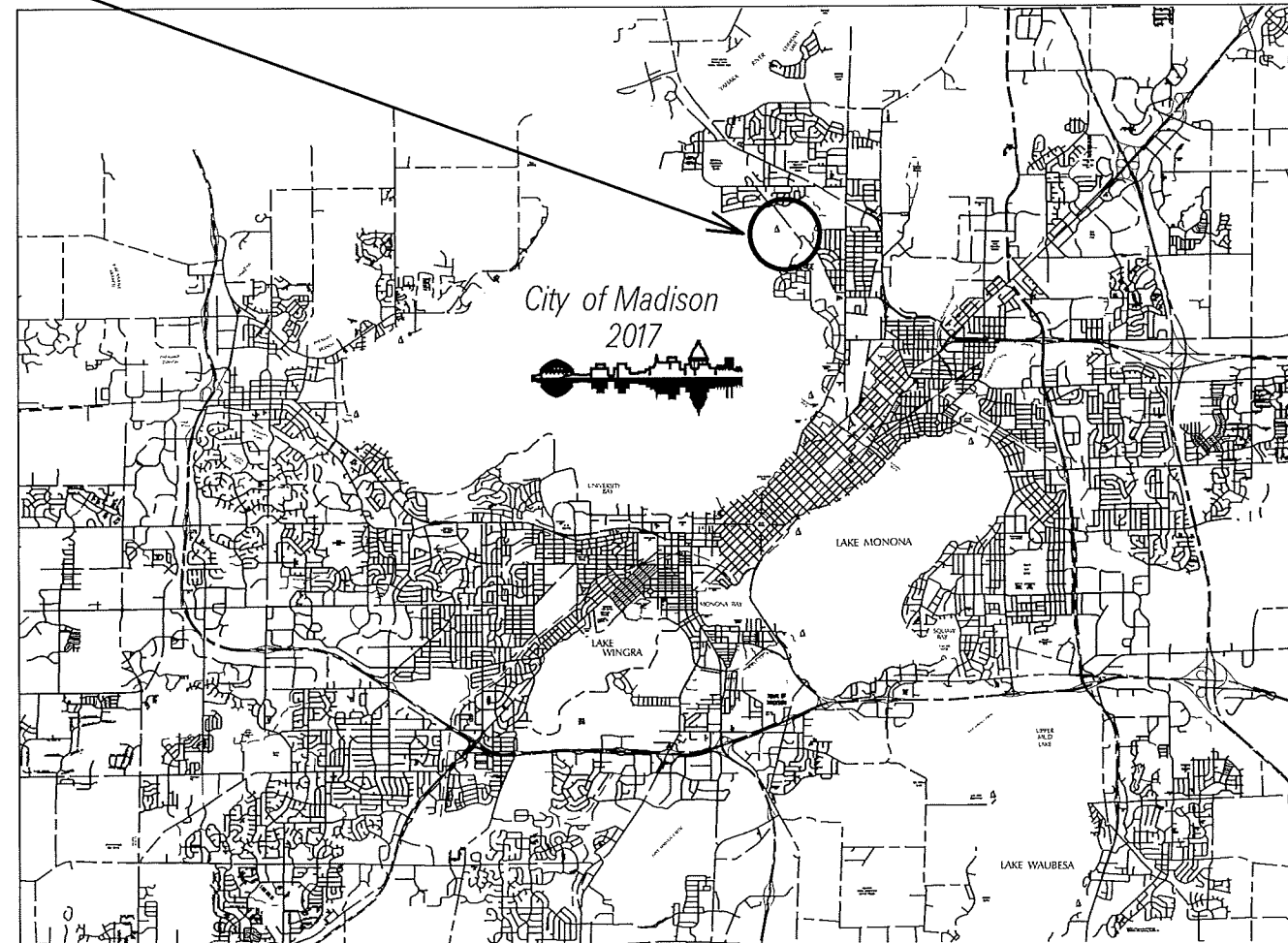

DESIGNED BY:



City of Madison
Department of Public Works
PARKS DIVISION

City-County Building, Suite 104
210 Martin Luther King, Jr. Blvd.
PO Box 2987
Madison, WI 53701-2987

play
**MADISON
PARKS**



PROJECT:

WARNER PARK BOAT
LAUNCH PARKING LOT
RECONSTRUCTION

Although every effort has been made in preparing these plans and checking them for accuracy, the contractor and subcontractors must check all details and dimensions of their trade and be responsible for the same.

Drawn by: CCS DATE: 7-27-18

SHEET TITLE:

TITLE

SHEET NUMBER:

1



CONTRACTOR SHALL STAGE EQUIPMENT AND MATERIALS ONLY WITHIN DISTURBANCE LIMITS. NO STAGING SHALL BE ALLOWED ON WOODWARD DR OR IN THE PARK OUTSIDE DISTURBANCE LIMITS.

-  CONSTRUCTION FENCE
-  CONSTRUCTION ENTRANCE STONE PAD
-  SILT SOCK

City of Madison
 Department of Public Works
PARKS DIVISION
 City-County Building, Suite 104
 210 Martin Luther King, Jr. Blvd.
 Madison, WI 53703

play
MADISON PARKS

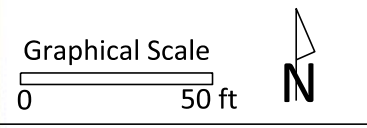

PROJECT:
**WARNER PARK
 BOAT LAUNCH
 PARKING LOT
 RECONSTRUCTION**

**WARNER PARK
 1101 WOODWARD DR
 MADISON, WI 53704**

Although every effort has been made in preparing these plans and checking them for accuracy, the contractor and subcontractors must check all details and dimensions of their trade and be responsible for the same.

ITEM	DATE
Drawn by: CCS	7-27-18

PUBLIC WORKS PROJECT #:
8220

SHEET TITLE:
**SITE ACCESS AND
 EROSION CONTROL**

SHEET NUMBER:
P-1

EROSION CONTROL NOTES:

EROSION CONTROL MEASURES SHALL BE IN PLACE PRIOR TO ANY OTHER CONSTRUCTION ACTIVITY.

THE CONTRACTOR IS RESPONSIBLE FOR THE CONSTRUCTION AND MAINTENANCE OF ALL EROSION CONTROL MEASURES UNTIL FINAL ACCEPTANCE BY THE CITY OF MADISON.

THE CONTRACTOR SHALL INSTALL AND MAINTAIN EROSION CONTROL MEASURES IN ACCORDANCE WITH THE WDNR SOC STANDARDS AND CITY OF MADISON STANDARD SPECIFICATIONS.

THE CONTRACTOR SHALL PROVIDE STREET CLEANING AS NEEDED ON A DAILY BASIS TO KEEP TRACKING TO A MINIMUM.

CONTRACTOR SHALL BE RESPONSIBLE FOR REQUIRED EROSION CONTROL REPORTING.

REMOVE EX CURB AND GUTTER-
ENTIRE LOT
(BLOCK STYLE CURB)

REMOVE AND REPLACE
KIOSK AND FEE DEPOSIT
POST (BID ITEM 90004)

REMOVE AND REPLACE
KIOSK AND FEE DEPOSIT
POST (BID ITEM 90004)

EX SIGNS TO
REMAIN

EX SIGNS ON WOODWARD DR
TO REMAIN

REMOVE INLET





PLUG

PLUG

ABANDON
EX STORM SEWER
WITH PLUGS

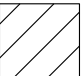
EXISTING TREES
TO REMAIN (TYR)

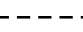
EX SIGNS ON WOODWARD DR
TO REMAIN

-  REMOVE EXISTING
TURF AND EXCAVATE TO SUBGRADE
-  REMOVE EXISTING ASPHALT
SURFACE AND EXCAVATE
TO SUBGRADE
-  REMOVE TREE
-  DISTURBANCE LIMITS
-  SAWCUT ASPHALT PAVEMENT
-  NO ROOT CUT PER BID ITEM 10803

City of Madison
Department of Public Works
PARKS DIVISION
City-County Building, Suite 104
210 Martin Luther King, Jr. Blvd.
Madison, WI 53703

play
**MADISON
PARKS**

Graphical Scale

0 50 ft



PROJECT:
**WARNER PARK
BOAT LAUNCH
PARKING LOT
RECONSTRUCTION**

**WARNER PARK
1101 WOODWARD DR
MADISON, WI 53704**

Although every effort has been made in preparing these plans and checking them for accuracy, the contractor and subcontractors must check all details and dimensions of their trade and be responsible for the same.

ITEM	DATE
Drawn by: CCS	7-27-18

PUBLIC WORKS PROJECT #:
8220

SHEET TITLE:
REMOVALS

SHEET NUMBER:
P-2

LEGEND

- SAN — EX. SANITARY SEWER
- ST — EX. STORM SEWER
- W — EX. WATER LINE
- E — EX. ELECTRIC
- OH — EX. OVERHEAD
- G — EX. GAS

SEE PAGES E1-E3 FOR ELECTRICAL
AND LIGHTING REMOVALS

CONTRACTOR SHALL BE RESPONSIBLE FOR ALL REPAIRS TO
EXISTING UTILITIES.

City of Madison
Department of Public Works
PARKS DIVISION

City-County Building, Suite 104
210 Martin Luther King, Jr. Blvd.
Madison, WI 53703

play
**MADISON
PARKS**

Graphical Scale

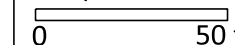

PROJECT:
**WARNER PARK
BOAT LAUNCH
PARKING LOT
RECONSTRUCTION**

**WARNER PARK
1101 WOODWARD DR
MADISON, WI 53704**

Although every effort has been made in preparing these plans and checking them for accuracy, the contractor and subcontractors must check all details and dimensions of their trade and be responsible for the same.

ITEM	DATE
Drawn by: CCS	7-27-18

PUBLIC WORKS PROJECT #:
8220

SHEET TITLE:
SITE GRADING

SHEET NUMBER:
P-3

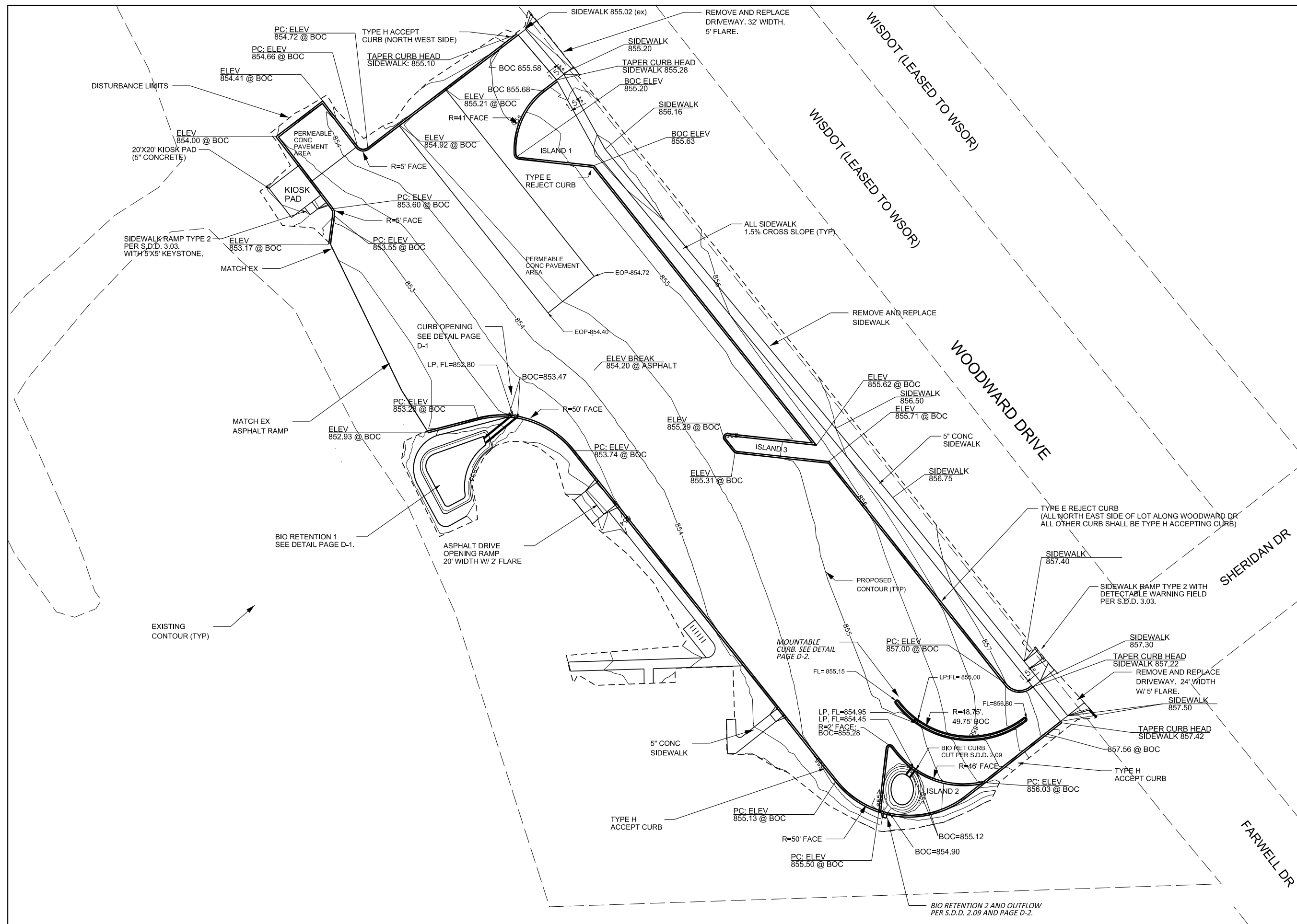

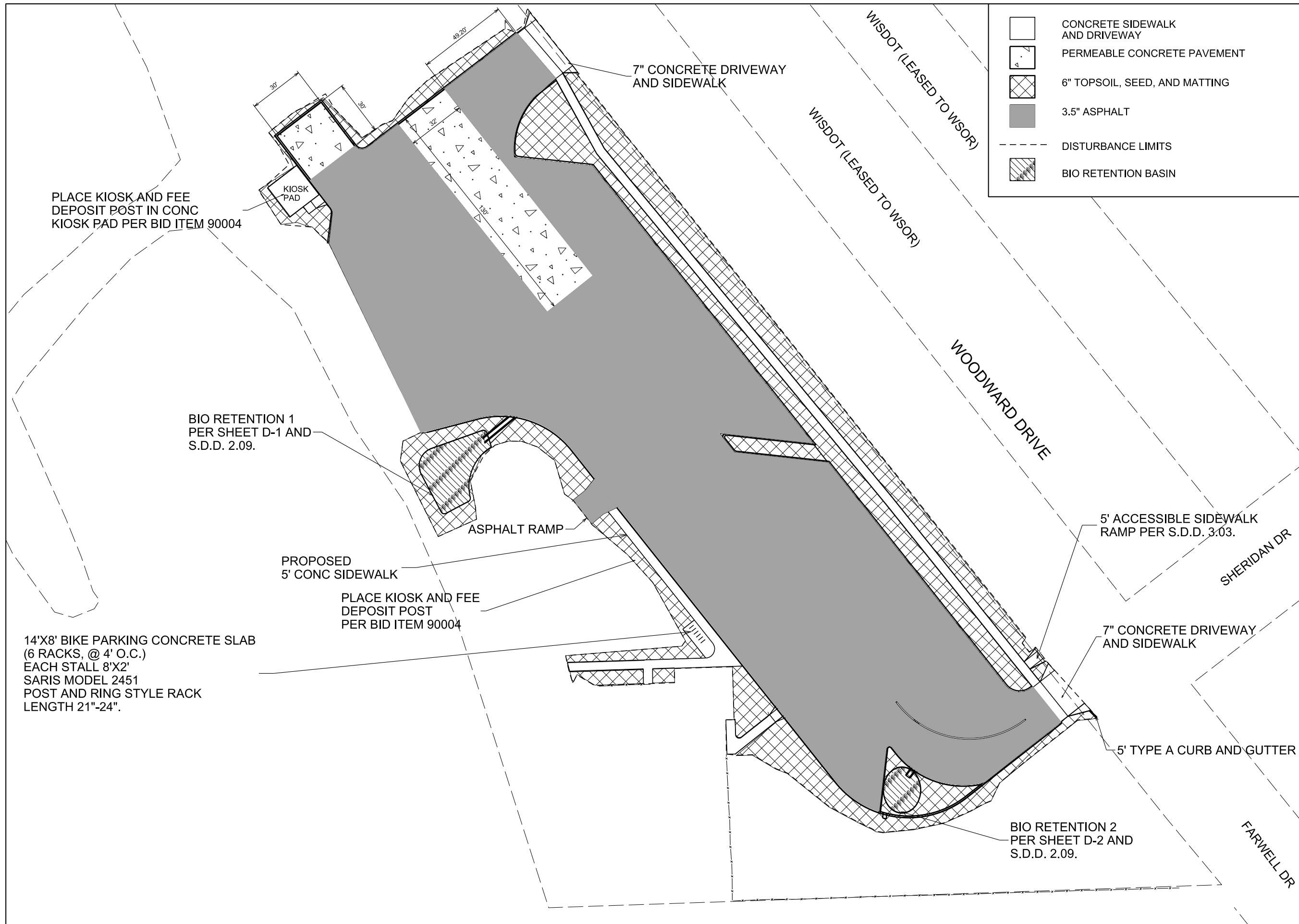

	CONCRETE SIDEWALK AND DRIVEWAY
	PERMEABLE CONCRETE PAVEMENT
	6" TOPSOIL, SEED, AND MATTING
	3.5" ASPHALT
	DISTURBANCE LIMITS
	BIO RETENTION BASIN

City of Madison
 Department of Public Works
PARKS DIVISION
 City-County Building, Suite 104
 210 Martin Luther King, Jr. Blvd.
 Madison, WI 53703

play
MADISON PARKS

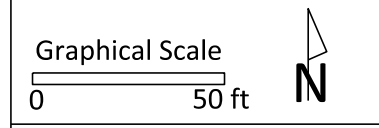

PROJECT:
**WARNER PARK
 BOAT LAUNCH
 PARKING LOT
 RECONSTRUCTION**

**WARNER PARK
 1101 WOODWARD DR
 MADISON, WI 53704**

Although every effort has been made in preparing these plans and checking them for accuracy, the contractor and subcontractors must check all details and dimensions of their trade and be responsible for the same.

ITEM	DATE
Drawn by: CCS	7-27-18

PUBLIC WORKS PROJECT #:
8220

SHEET TITLE:
**RESTORATION AND
 SITE MATERIALS**

SHEET NUMBER:
P-4

ACCESSIBLE STALL STRIPING
4" LINES 1' O.C. AT 45 DEG

'ONE WAY' SIGN

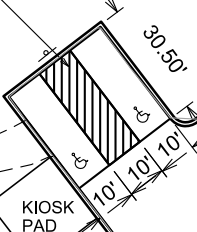

KIOSK PAD

32' CENTER DRIVE AISLE









ACCESSIBLE STALL STRIPING
4" LINES 1' O.C. AT 45 DEG

45 DEG ANGLED STALLS (TYP)

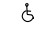
EXISTING ASPHALT DRIVE AND SIDEWALK TO REMAIN

MONONA SAILING CENTER BUILDING

TYPE 'H' CONCRETE CURB AND GUTTER PER S.D.D. 3.08

-  PROPOSED PARKING STALL MARKING PER BID ITEM 60800
-  PROPOSED TRAFFIC MARKING STRAIGHT ARROW PER BID ITEM 60831
-  PAVEMENT MARKING ACCESSIBLE STALLS PER BID ITEM 60821
-  DRIVE LANE DIVIDER MARKING 6 INCH PER BID ITEM 60802
-  PAVEMENT MARKING LEFT ARROW PER BID ITEM 60829
-  ACCESSIBLE PARKING STALL SIGN
-  STOP OR ONE WAY SIGN
-  SINGLE VEHICLE ONLY- NO TRAILERS SIGN

City of Madison
Department of Public Works
PARKS DIVISION
City-County Building, Suite 104
210 Martin Luther King, Jr. Blvd.
Madison, WI 53703

play
MADISON PARKS

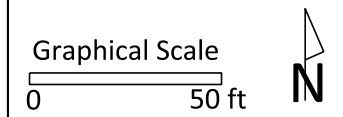

PROJECT:
**WARNER PARK
BOAT LAUNCH
PARKING LOT
RECONSTRUCTION**

**WARNER PARK
1101 WOODWARD DR
MADISON, WI 53704**

Although every effort has been made in preparing these plans and checking them for accuracy, the contractor and subcontractors must check all details and dimensions of their trade and be responsible for the same.

ITEM	DATE
Drawn by: CCS	7-27-18

PUBLIC WORKS PROJECT #:
8220

SHEET TITLE:
**TRAFFIC MARKINGS
AND SIGNAGE**

SHEET NUMBER:
P-5

NOTE: THE RIGHT-OF-WAY IS THE SOLE JURISDICTION OF THE CITY OF MADISON AND IS SUBJECT TO CHANGE AT ANY TIME PER THE RECOMMENDATION/PLAN OF TRAFFIC ENGINEERING AND CITY ENGINEERING DEPARTMENTS.

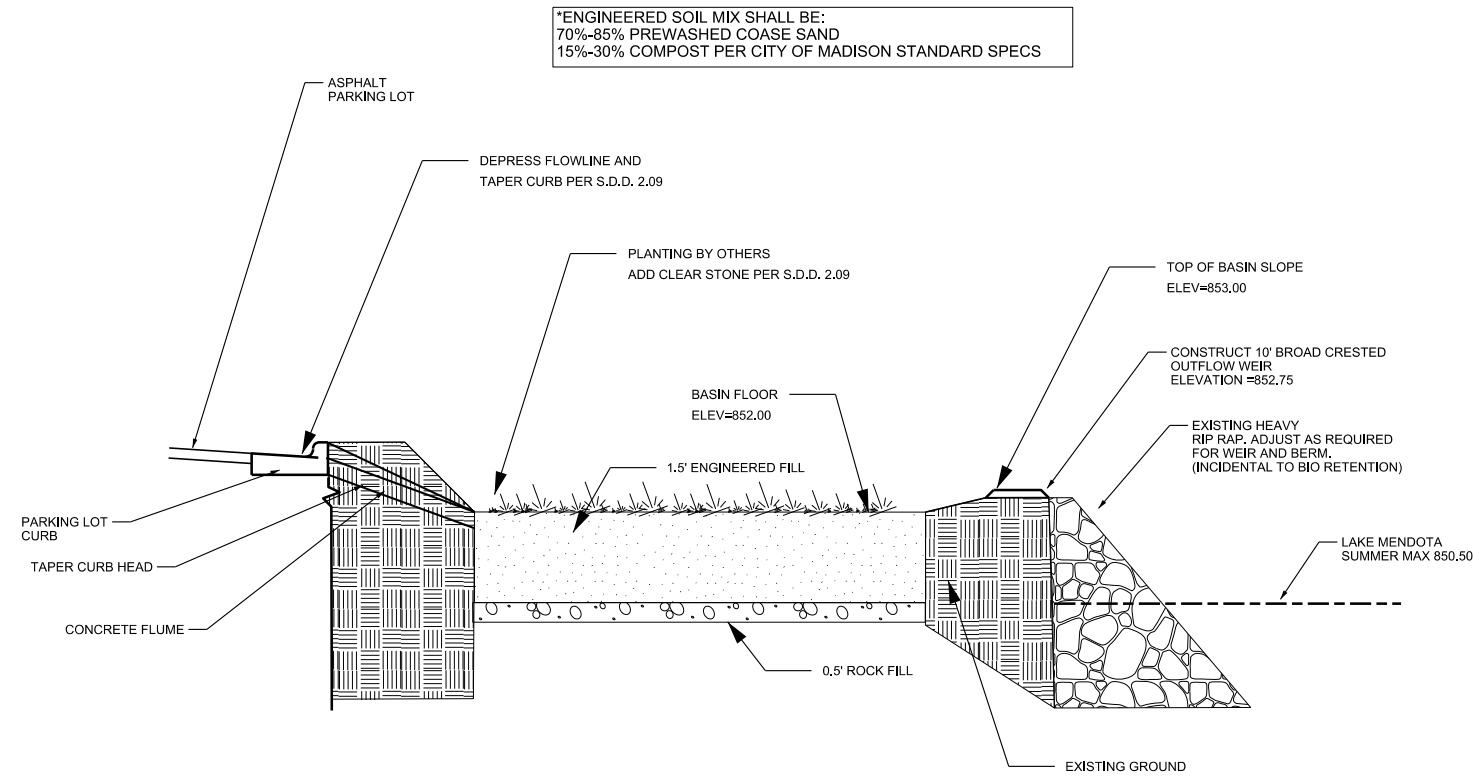

BIO RETENTION 1 DETAIL

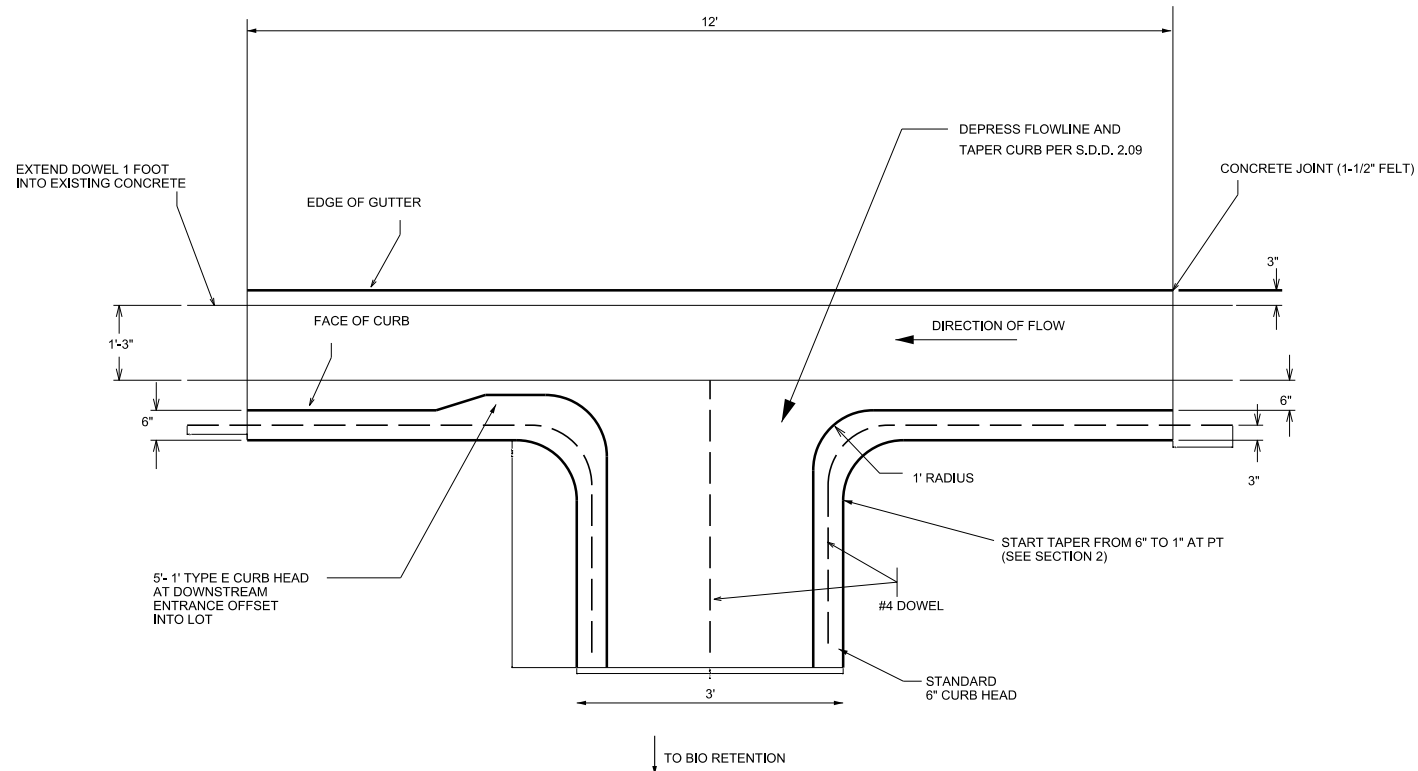

BIO RETENTION 1 FLUME AND CURB DETAIL

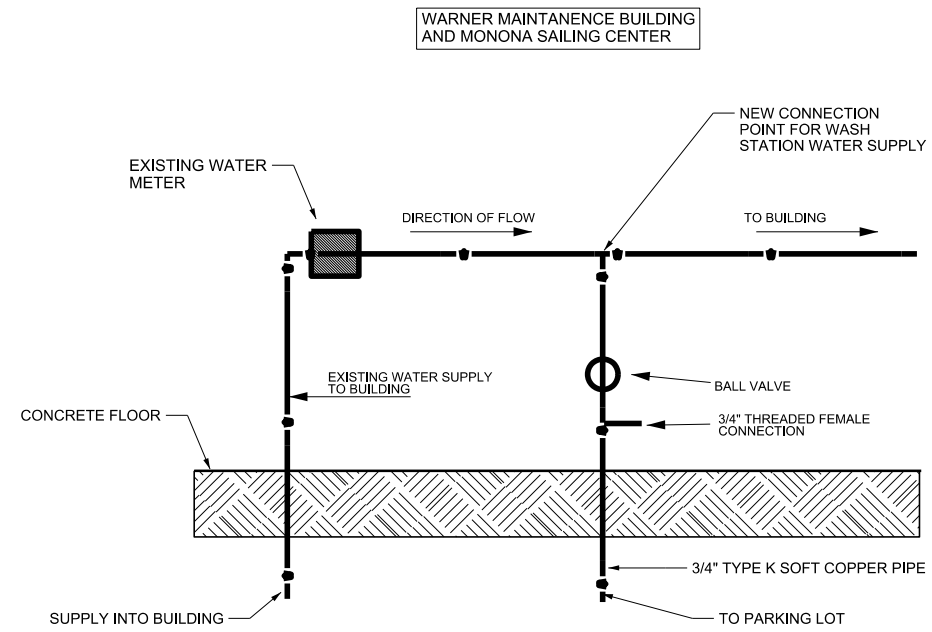

WATER SUPPLY DETAIL

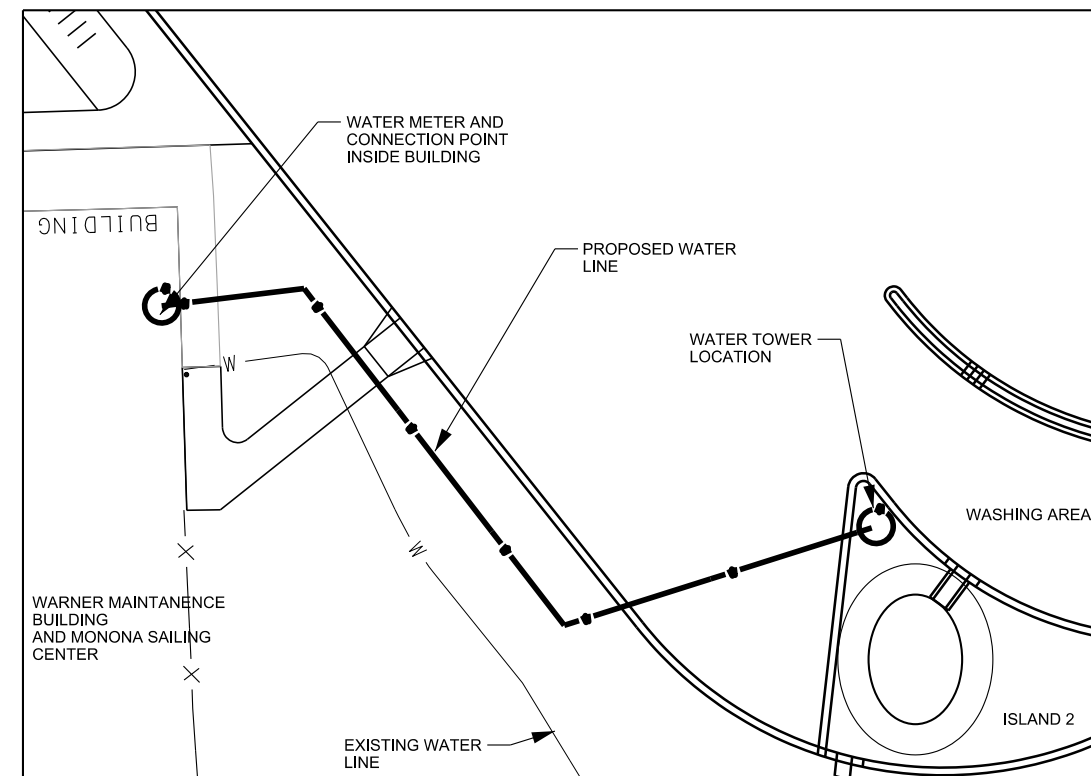

WASH STATION WATER SUPPLY

City of Madison
Department of Public Works
PARKS DIVISION
City-County Building, Suite 104
210 Martin Luther King, Jr. Blvd.
Madison, WI 53703

play
**MADISON
PARKS**

NOT TO SCALE

PROJECT:
**WARNER PARK
BOAT LAUNCH
PARKING LOT
RECONSTRUCTION**

**WARNER PARK
1101 WOODWARD DR
MADISON, WI 53704**

Although every effort has been made in preparing these plans and checking them for accuracy, the contractor and subcontractors must check all details and dimensions of their trade and be responsible for the same.

ITEM	DATE
Drawn by: CCS	7-27-18

PUBLIC WORKS PROJECT #:
8220

SHEET TITLE:
DETAILS

SHEET NUMBER:
D-1

NOT TO SCALE

PROJECT:
**WARNER PARK
 BOAT LAUNCH
 PARKING LOT
 RECONSTRUCTION**

**WARNER PARK
 1101 WOODWARD DR
 MADISON, WI 53704**

Although every effort has been made in preparing these plans and checking them for accuracy, the contractor and subcontractors must check all details and dimensions of their trade and be responsible for the same.

ITEM	DATE
Drawn by: CCS	7-27-18

PUBLIC WORKS PROJECT #:
8220

SHEET TITLE:
DETAILS

SHEET NUMBER:
D-2

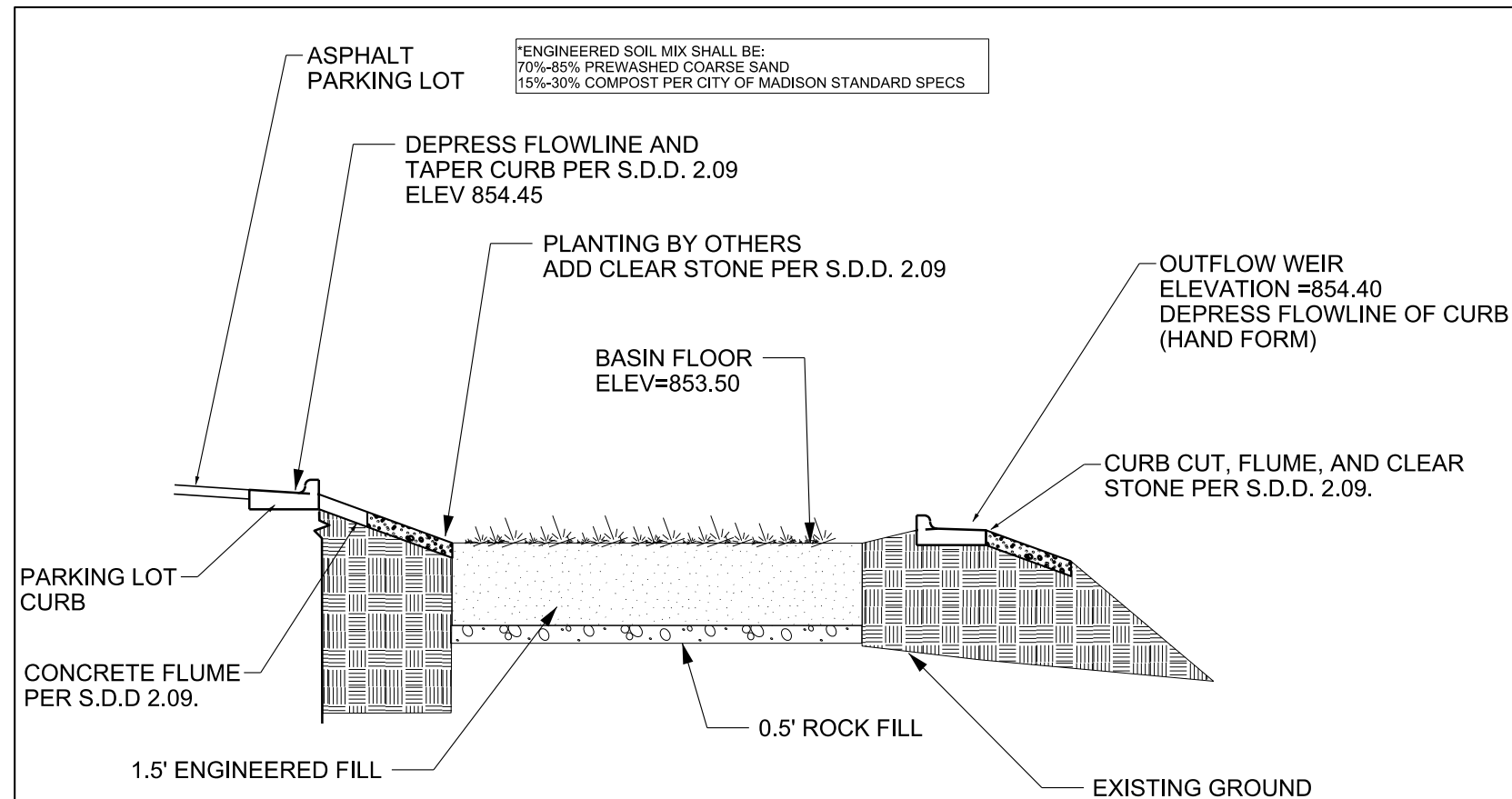

BIO RETENTION 2 DETAIL

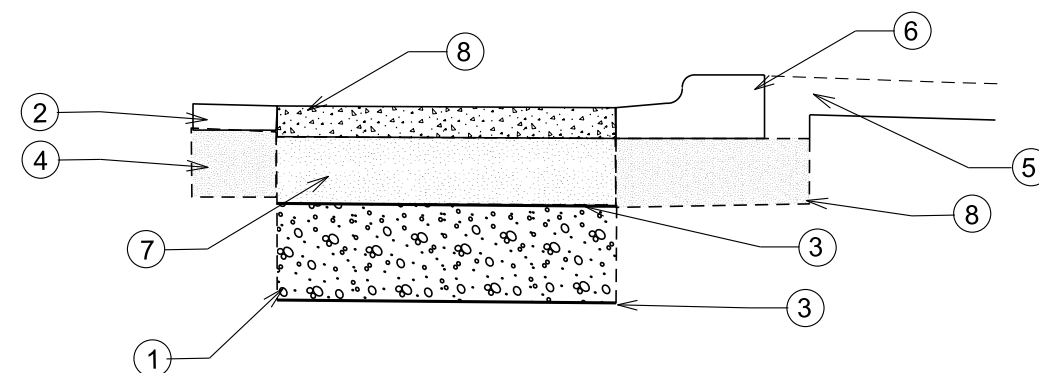

PERMEABLE PAVEMENT CROSS SECTION

- ① AGGREGATE STORAGE LAYER
- ② 3.5" HMA 4 LT 58-28 S ASPHALT PAVEMENT
- ③ FILTER FABRIC
- ④ 12" CRUSHED AGGREGATE BASE COURSE GRAD 2; EXTEND 6" BEYOND CURB
- ⑤ 6" TOPSOIL
- ⑥ CURB AND GUTTER
- ⑦ WASHED AGGREGATE BASE COURSE
- ⑧ 6" PERMEABLE PRECASE CONCRETE

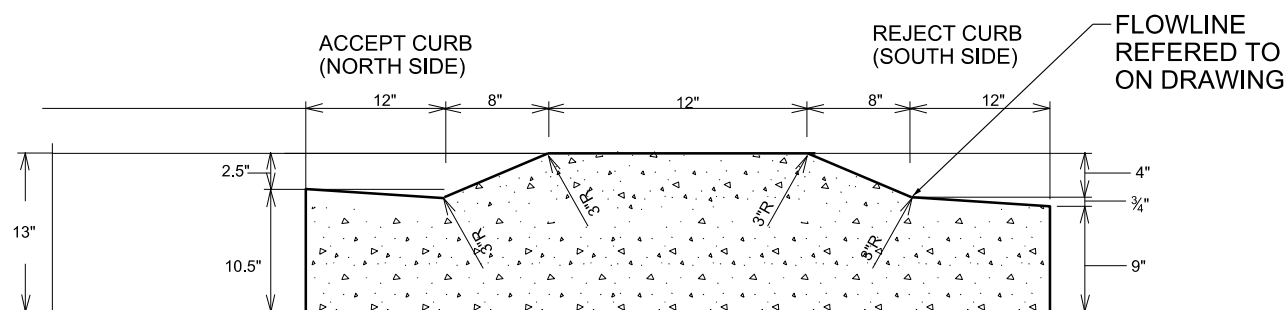

MOUNTABLE CURB

GENERAL NOTES:

LATERAL CONTRACTION JOINTS SHALL BE PLACED AT INTERVALS OF NOT MORE THAN 15' NOR LESS THAN 6' IN LENGTH. THE JOINTS SHALL BE A MINIMUM OF 3" IN DEPTH

EXPANSION JOINTS SHALL BE PLACED TRANSVERSLY AT RADIUS POINTS ON CURVES OF RADIUS 200' OR LESS, AND AT ANGLE POINTS, OR AS DIRECTED BY THE ENGINEER. THE EXPANSION JOINT SHALL BE A ONE PIECE ASPHALTIC MATERIAL HAVING THE SAME DIMENSIONS AS CURB & GUTTER AT THAT STATION AND BE 1/2" THICK.

IN ALL CASES, CONCRETE CURB & GUTTER SHALL BE PLACED ON THOROUGHLY COMPACTED CRUSHED STONE

City of Madison
 Department of Public Works
PARKS DIVISION

City-County Building, Suite 104
 210 Martin Luther King, Jr. Blvd.
 Madison, WI 53703

play
**MADISON
 PARKS**

SCALE: 1"=20'

PROJECT:
**WARNER PARK
 BOAT LAUNCH
 PARKING LOT
 RECONSTRUCTION**

**WARNER PARK
 1101 WOODWARD DR
 MADISON, WI 53704**

Although every effort has been made in preparing these plans and checking them for accuracy, the contractor and subcontractors must check all details and dimensions of their trade and be responsible for the same.

ITEM	DATE
Drawn by: CCS	7-27-18

PUBLIC WORKS PROJECT #:
8220

SHEET TITLE:
DETAILS

SHEET NUMBER:
D-3

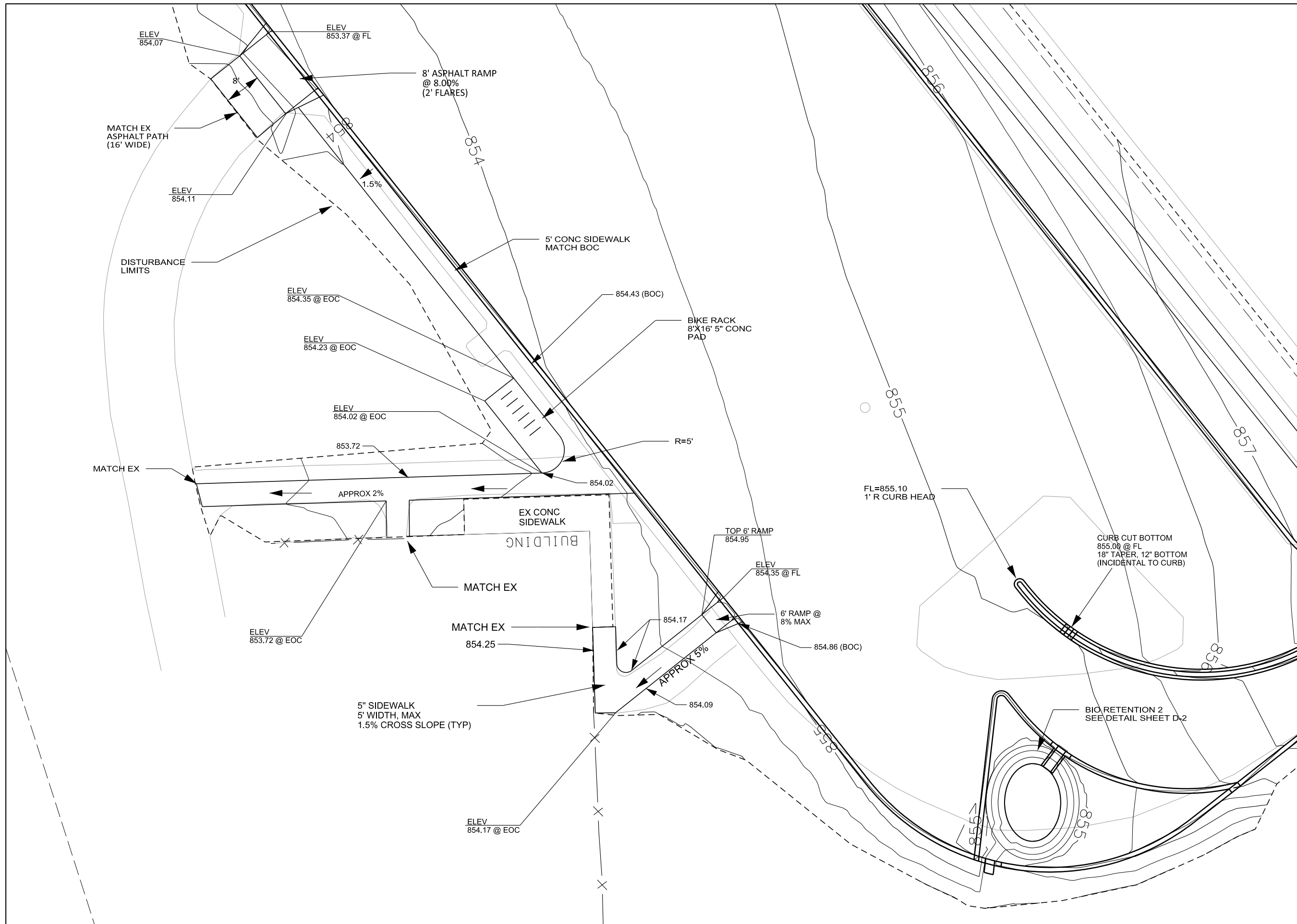



PROJECT:
*WARNER PARK
BOAT LAUNCH
PARKING LOT*

*WARNER PARK
1101 WOODWARD DR
MADISON, WI 53704*

Although every effort has been made in preparing these plans and checking them for accuracy, the contractor and subcontractors must check all details and dimensions of their trade and be responsible for the same.

ITEM	DATE
Drawn by: JAJ	7-6-2018

PUBLIC WORKS PROJECT #:
8022

SHEET TITLE:
ELECTRICAL PLAN

SHEET NUMBER:
E-1

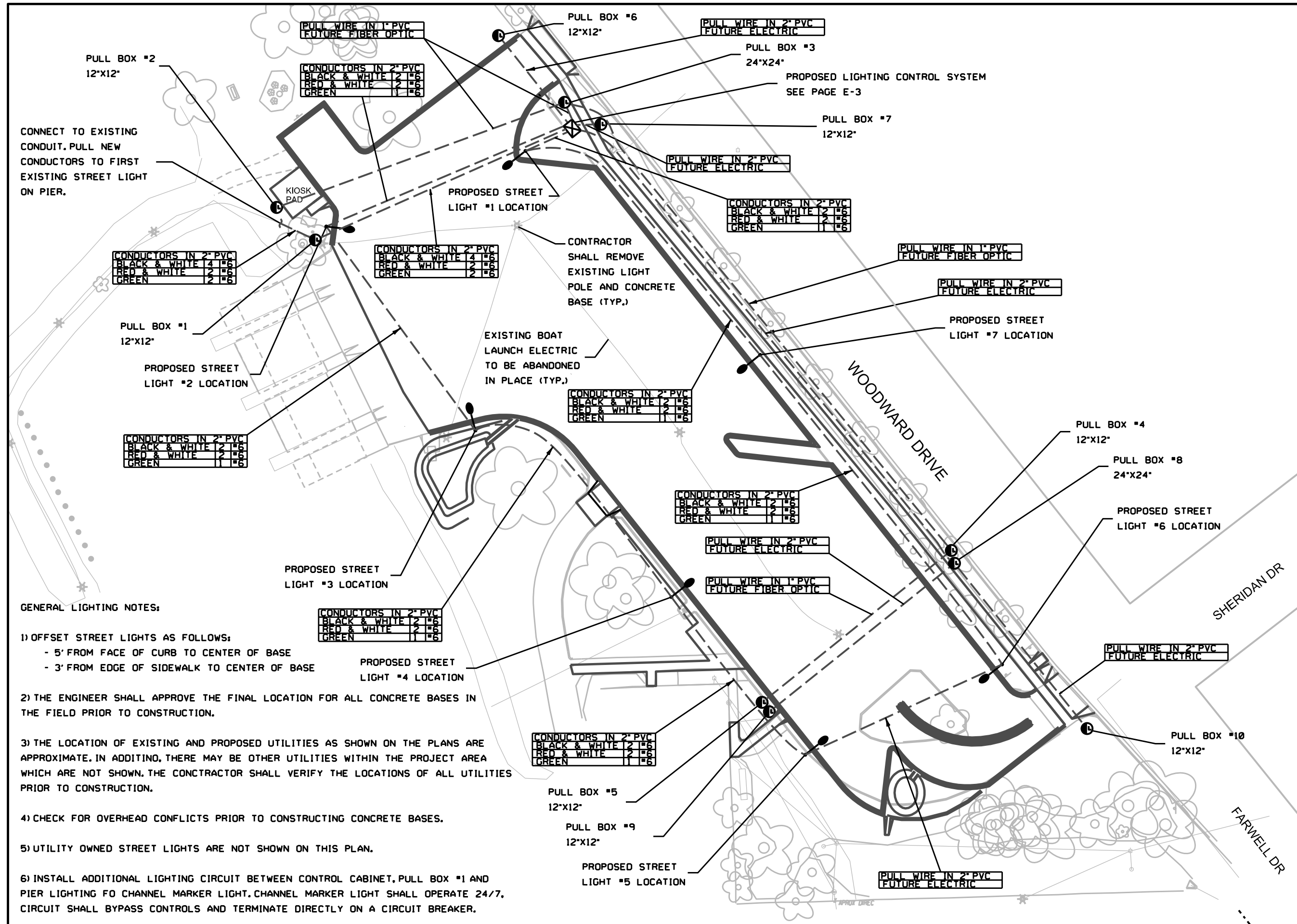

GENERAL LIGHTING NOTES:

- 1) OFFSET STREET LIGHTS AS FOLLOWS:
 - 5' FROM FACE OF CURB TO CENTER OF BASE
 - 3' FROM EDGE OF SIDEWALK TO CENTER OF BASE
- 2) THE ENGINEER SHALL APPROVE THE FINAL LOCATION FOR ALL CONCRETE BASES IN THE FIELD PRIOR TO CONSTRUCTION.
- 3) THE LOCATION OF EXISTING AND PROPOSED UTILITIES AS SHOWN ON THE PLANS ARE APPROXIMATE. IN ADDITINO, THERE MAY BE OTHER UTILITIES WITHIN THE PROJECT AREA WHICH ARE NOT SHOWN. THE CONTRACTOR SHALL VERIFY THE LOCATIONS OF ALL UTILITIES PRIOR TO CONSTRUCTION.
- 4) CHECK FOR OVERHEAD CONFLICTS PRIOR TO CONSTRUCTING CONCRETE BASES.
- 5) UTILITY OWNED STREET LIGHTS ARE NOT SHOWN ON THIS PLAN.
- 6) INSTALL ADDITIONAL LIGHTING CIRCUIT BETWEEN CONTROL CABINET, PULL BOX #1 AND PIER LIGHTING FO CHANNEL MARKER LIGHT. CHANNEL MARKER LIGHT SHALL OPERATE 24/7. CIRCUIT SHALL BYPASS CONTROLS AND TERMINATE DIRECTLY ON A CIRCUIT BREAKER.



PROJECT:

*WARNER PARK
BOAT LAUNCH
PARKING LOT*

*WARNER PARK
1101 WOODWARD DR
MADISON, WI 53704*

Although every effort has been made in preparing these plans and checking them for accuracy, the contractor and subcontractors must check all details and dimensions of their trade and be responsible for the same.

ITEM _____ DATE _____
Drawn by: JAJ 7-6-2018

PUBLIC WORKS PROJECT #:
8022

SHEET TITLE:
ELECTRICAL PLAN

SHEET NUMBER:
E-2

NOTES:

- ① TYPE AND DEPTH OF ANCHOR BOLT AS PER MANUFACTURER SPECIFICATIONS
- ② (6) NO. 4 BAR STEEL REINFORCEMENT SPACED EQUALLY AROUND.
- ③ NO. 4 BAR STEEL REINFORCEMENT AT 12".

A NO. 4 AWG STRANDED COPPER EQUIPMENT GROUNDING CONDUCTOR SHALL BE EXOTHERMICALLY WELDED OR COMPRESSION CRIMPED TO THE GROUNDING ELECTRODE.

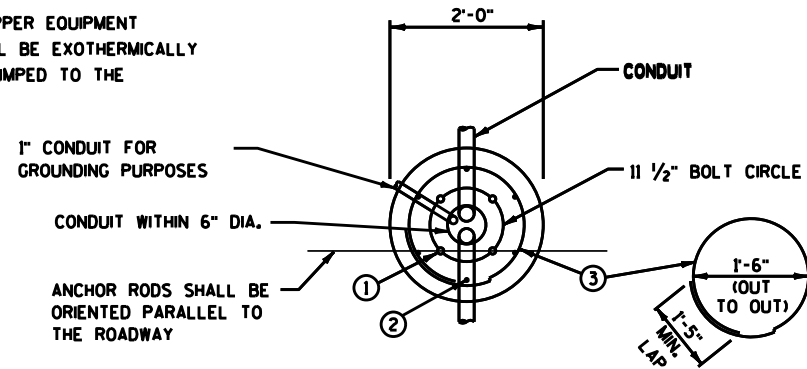

FORM ALL EXPOSED CONCRETE. PROVIDE 1" CHAMFER ALL AROUND

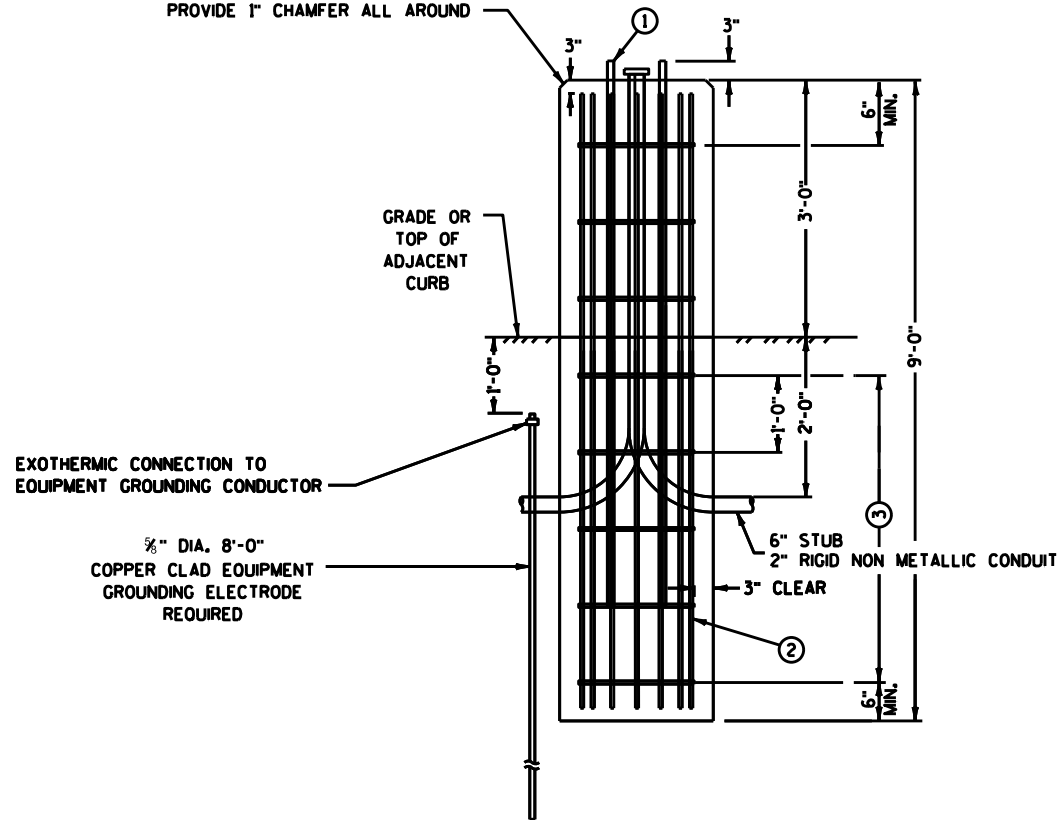

CONCRETE BASE
NO SCALE

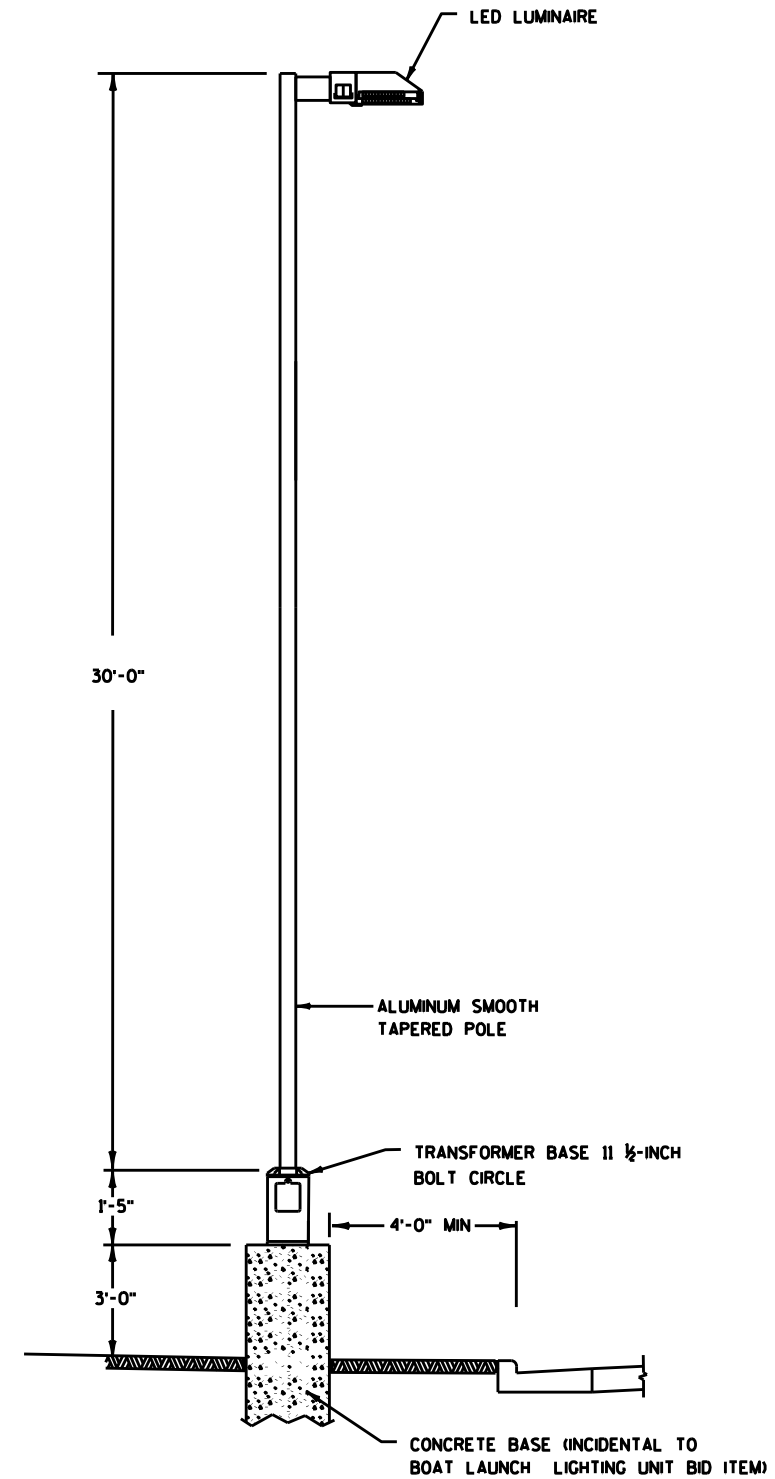

BOAT LAUNCH LIGHTING UNIT DETAIL
NO SCALE

Graphical Scale

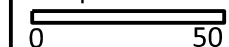

PROJECT:

**WARNER PARK
BOAT LAUNCH
PARKING LOT**

**WARNER PARK
1101 WOODWARD DR
MADISON, WI 53704**

Although every effort has been made in preparing these plans and checking them for accuracy, the contractor and subcontractors must check all details and dimensions of their trade and be responsible for the same.

ITEM	DATE
Drawn by: JAJ	7-6-2018

PUBLIC WORKS PROJECT #:

8022

SHEET TITLE:

ELECTRICAL PLAN

SHEET NUMBER:

E-3

SAGINAW ENCLOSURE
TO BE CENTERED ON CONCRETE PAD
MODEL #604816LP
60"X48"X16" DEEP
WITH DRIPSHIELD SCE-DS48N4

SAGINAW ENCLOSURE
TO BE CENTERED ON CONCRETE PAD
MODEL #604816LP
60"X48"X16" DEEP
WITH DRIPSHIELD SCE-DS48N4

NEW MILBANK U5784-0-200-5T-CB
METER MAIN MOUNTED ON BACK
OF SAGINAW ENCLOSURE.

SAGINAW ENCLOSURE
TO BE CENTERED ON CONCRETE PAD
MODEL #604816LP
60"X48"X16" DEEP
WITH DRIPSHIELD SCE-DS48N4

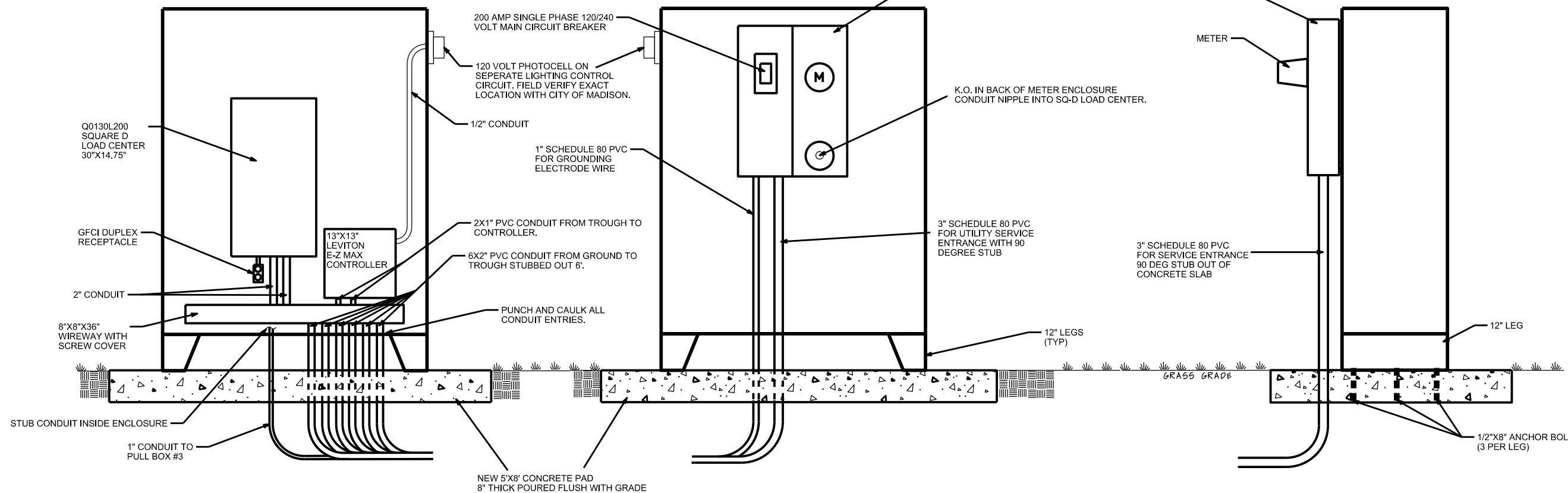

INSIDE VIEW

BACK VIEW

SIDE VIEW

GENERAL NOTES:

- 1) CONTRACTOR TO ARRANGE EQUIPMENT TO ALLOW MAXIMUM SPACE INSIDE ENCLOSURE FOR FUTURE COMPONENT INSTALLATION.

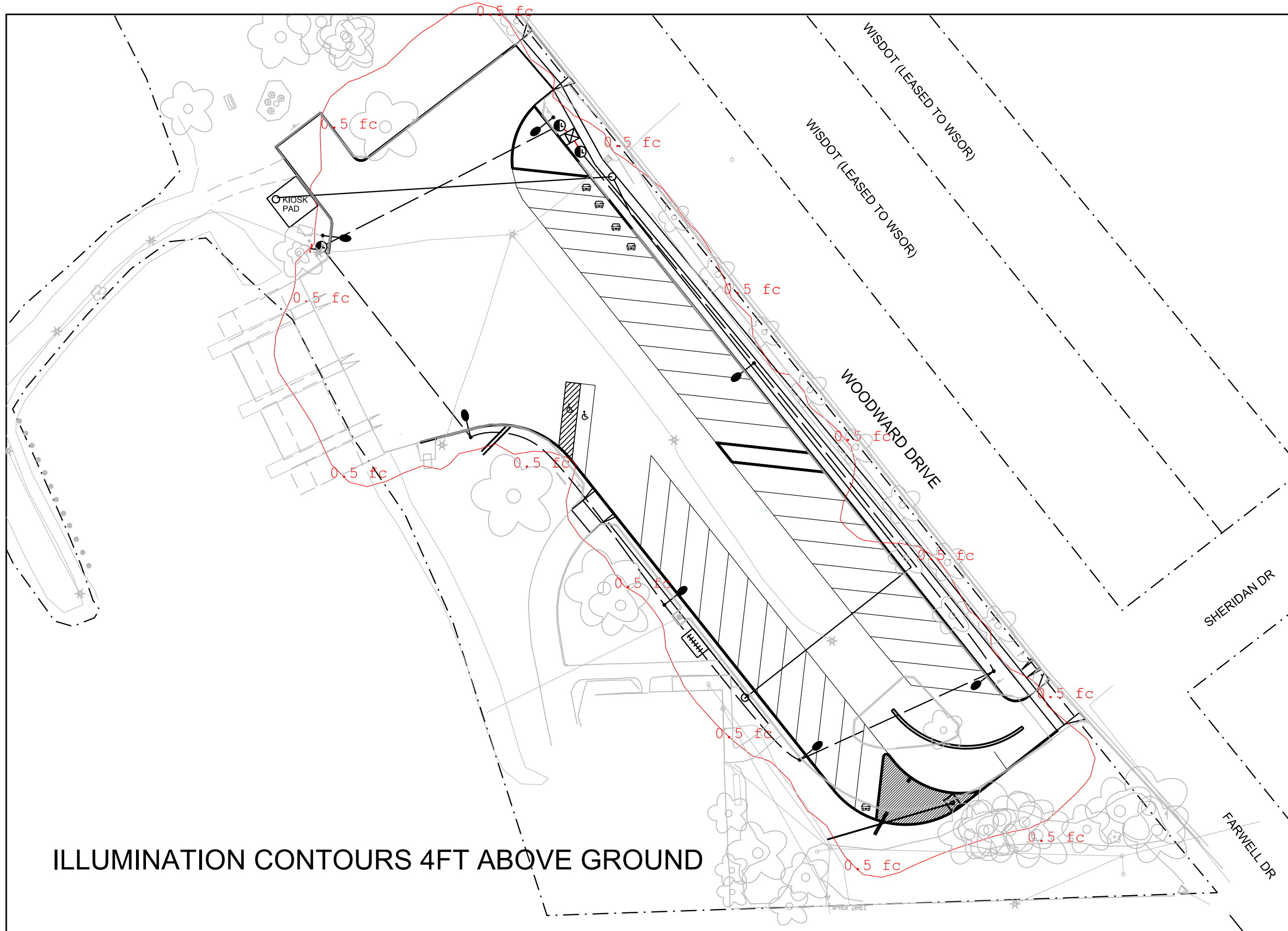

ILLUMINATION CONTOURS 4FT ABOVE GROUND



5400 King James Way
Suite 200
Madison, WI 53719
(608)-663-1218 Office
800-810-4012
www.klengineering.com

Graphical Scale

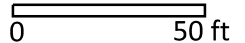

PROJECT:
**WARNER PARK
BOAT LAUNCH
PARKING LOT**

**WARNER PARK
1101 WOODWARD DR
MADISON, WI 53704**

Although every effort has been made in preparing these plans and checking them for accuracy, the contractor and subcontractors must check all details and dimensions of their trade and be responsible for the same.

ITEM	DATE
Drawn by:	xx-xx-xxxx
Approved by:	xx-xx-xxxx

PUBLIC WORKS PROJECT #:
8022

SHEET TITLE:
LIGHTING PLAN

SHEET NUMBER:
E-4

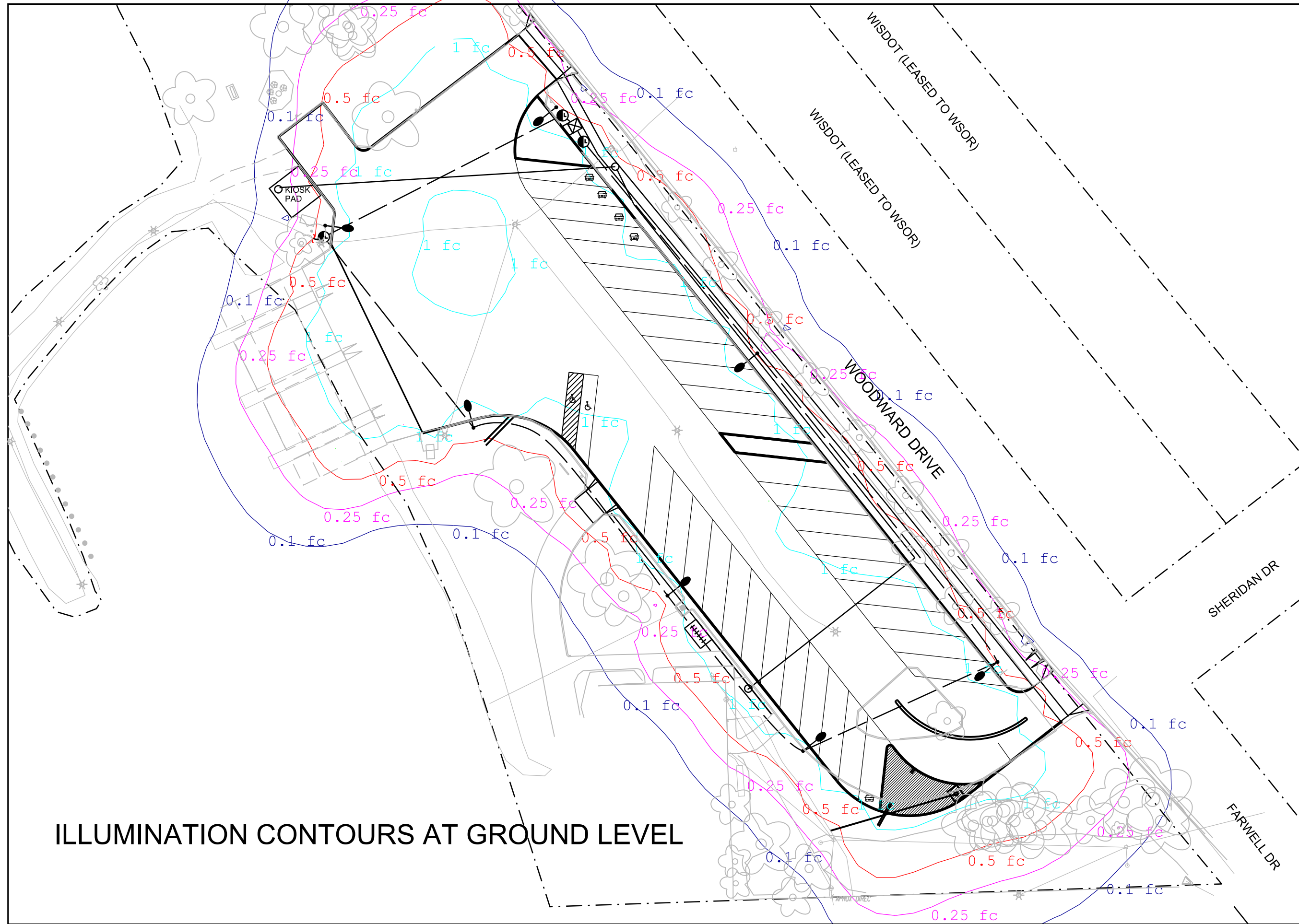

ILLUMINATION CONTOURS AT GROUND LEVEL



5400 King James Way
Suite 200
Madison, WI 53719
(608)-663-1218 Office
800-810-4012
www.klengineering.com

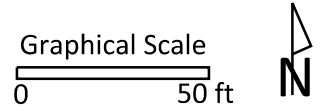

PROJECT:
**WARNER PARK
BOAT LAUNCH
PARKING LOT**

**WARNER PARK
1101 WOODWARD DR
MADISON, WI 53704**

Although every effort has been made in preparing these plans and checking them for accuracy, the contractor and subcontractors must check all details and dimensions of their trade and be responsible for the same.

ITEM	DATE
Drawn by:	xx-xx-xxxx
Approved by:	xx-xx-xxxx

PUBLIC WORKS PROJECT #:
8022

SHEET TITLE:
LIGHTING PLAN

SHEET NUMBER:
E-5